

REWITNESSED CORNER FOR STATE OF OREGON - DEPARTMENT OF FORESTRY

One quarter corner to Section 26 (west side), T2S, R9W, W.M.,
Tillamook County, Oregon.

ORIGINAL by Samuel D. Snowden, August 10, 1857.

Post; missing, from which a:

32" Hemlock bears $S67^{\circ}E$ 42 lks; missing.
16" Hemlock bears $S75^{\circ}W$ 20 lks; missing.

NOTE: Henry Meldrum was unable to find this point when completing
the survey of this township and failed to reestablish this
corner when resurveying the line June 17, 1884.

REESTABLISHMENT by Richard A. Morris LS401, April 14, 1959, (Book
1, Page 373, Tillamook Co. Records).

1 1/2"x36" galvanized iron pipe with 3" bronze cap; found
in place, from which a:

15" Hemlock bears $N52\ 1/2^{\circ}E$ 18.1 ft.; now a 15" stump
with scribes 1/4 S26 BT RS401 visible.
4"x4"x56" white painted Cedar post 1.0 ft. NE of pipe; in place.

REWITNESSED August 7, 1987 Var. $21\ 1/2^{\circ}E$
From above pipe, added marks "LS1998 1987" and from which a:

16" Hemlock bears $N38^{\circ}W$ 15.3 ft. to face; scribed S27BT.
20" Hemlock bears $S50^{\circ}E$ 26.8 ft. to face; scribed 1/4S26BT.

Metal location poster on new BTs.
3/4" brass washer marked "LS1998" nailed to face of new BTs.
Also poster on 8" Hemlock $S78^{\circ}E$ 14.8 ft.; now 17", in place.
Present and witnessed be David B. Buchholz and Clifford R. Foster.

Rewitnessed by

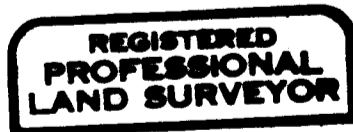

Anthony J. Klosterman

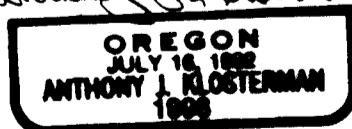

BOOK 6 19 0008 BOOK 6